

Installation Instructions



Attention! This document is a guide only. This product may not be suitable for every application. The user is responsible for all necessary applications engineering and design. Please scan the QR code to the right for additional information, warnings and disclaimers regarding product use.

You can also view load test results at www.S-5.com where applicable, or contact your S-5! distributor for more information.

S-5-HR pairs with the S-5! PVKIT[®] for rail-less solar mounting on Steel & Tube[®] Hi-Rib[®] roof profiles.

What's Included in Your Box

S-5-HR™



Based on 1 Part

- 1 – M8 x 30 mm T-30 drive bolt

Minor Box Qty: 70*

Master Box Qty: 210*

*Broken-box quantities may vary

What You'll Need for Installation

- Screw Gun
- String line
- Tape measure
- T30 Torx Bit Tip (provided)
- Dial-Calibrated Torque Wrench

(For accurate tension values, do NOT use a clicking torque wrench).

How to Install the S-5-HR

The S-5-HR has a single piece design that snaps over the roof seam, then uses a stainless steel fastener to compress the part to the roof panel. The clamp body features a threaded M8 hole for use with the PVKIT or other utility purposes.

Determine the location of your first row of clamps. To ensure a straight line, install a single S-5-HR on each end of the roof at a measured, consistent distance from the eave or ridge of the roof. Use a string line between the two clamps as a guide to ensure the remaining HR clamps create a straight row. **(Fig 1)**

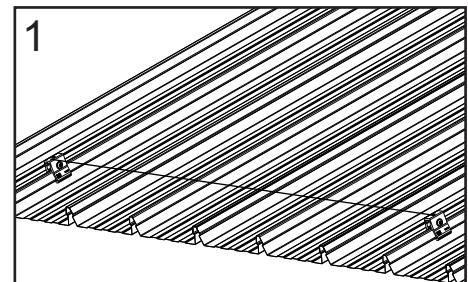

1. Begin installing the included M8 bolt by hand into the body of the HR clamps. **(Fig 2)**

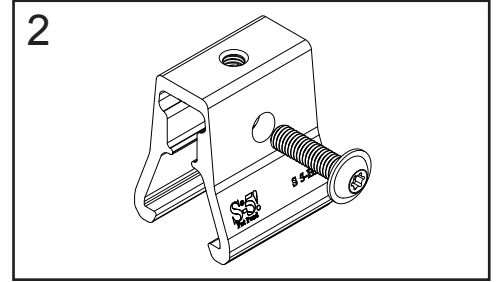

2. Once the clamps are assembled, place the clamp over the seam in the desired location; then, press down on the clamp to snap the clamp over the roof seam. **(Fig 3a & 3b)**

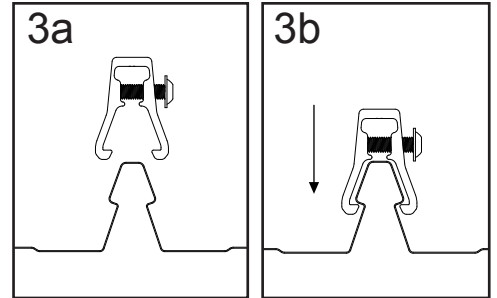

3. Tighten the installed M8 bolt to 160 - 180 inch pounds (18 – 20 Nm). The body of the HR clamp will compress to engage the roof profile.

4. The clamp is now ready to add the PVKIT® by screwing the standoff through the M8 hole on top of the clamp. **(Fig 4)** This can also be pre-assembled prior to clamp installation.

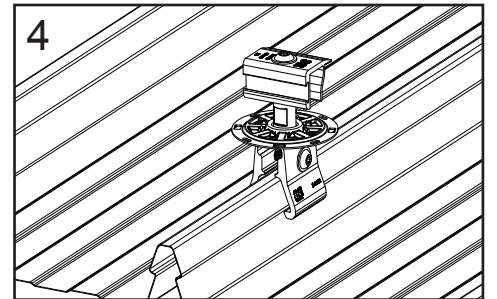

Once installed correctly, the mechanical connection established with this clamp requires no maintenance or torque re-inspection for the life of the roof.

NOTE: Any S-5! warranty and/or calculation may be void if hardware is used that was not furnished by S-5! directly or through one of their licensed distributors or any assembly that has not been tested by S-5!

These instructions are for use by those experienced in the trade. Always follow appropriate safety precautions and use appropriate tools.

S-5!® Warning! Please use this product responsibly!

Products are protected by multiple U.S. and foreign patents. For published data regarding holding strength, fastener torque, patents and trademarks, visit the S-5! website at www.S-5.com. Copyright 2023, Metal Roof Innovations, Ltd. S-5! products are patent protected. S-5! aggressively protects its patents, trademarks and copyrights. S-5-HR-Installation 11-17_23